



# \*THE HEIMAT\*

Enjoy delight your whole life long.



Your home in Arlberg

## Home is where the heart beats faster.

Do you feel your heart beating? Do you see the panorama? Do you hear the silence? Breathe deeply. And dream you are in the place you would love to be: Beyond Nessleg in Arlberg – the sun-kissed address for your new apartment to live in, to have a holiday in and to profit from.

\*\*\*\*\*



Nesslegg 38, 6888 Schröcken, Österreich



## — 01 — the arlberg

by Johannes Humml



## — 02 — the northern

by Verena Hochrainer



If furnishings are the real question regarding the style, you will find three absolutely perfect answers here.

\*\*\*\*\*

All three furnishing styles are made of regional and durable raw materials. «the alberg» furnishing style is included in the purchase price. «the northern» and «the modern» are optional at extra charge.

## — 03 — the modern

by Verena Hochrainer





## \* THE HEIMAT \*

### House A TOP A01.01

Level 1

No. of rooms	1
Size	ca. 41,73 m <sup>2</sup>
Terasse	ca. 15,79 m <sup>2</sup>
Condition	New construction
Orientation	Northwest
Parking area	On demand

#### Holiday home permission »new«

— You will find more information regarding the permission at [theheimat.at](http://theheimat.at) or in the brochure

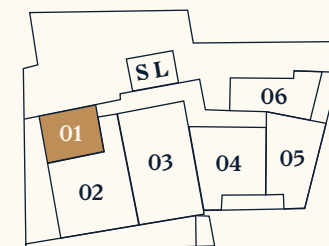
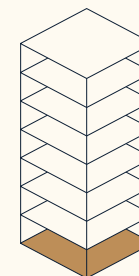

S — Staircase  
L — Lift





## \* THE HEIMAT \*

### House A TOP A01.02

Level 1

No. of rooms	3
Size	ca. 119,66 m <sup>2</sup>
Terasse	ca. 88,15 m <sup>2</sup>
Condition	New construction
Orientation	Southwest
Parking area	On demand

#### Holiday home permission »new«

— You will find more information regarding the permission at [theheimat.at](http://theheimat.at) or in the brochure

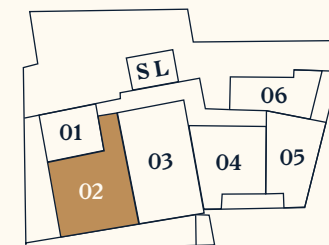
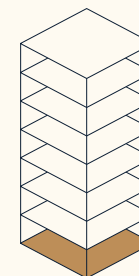

S — Staircase  
L — Lift





## \* THE HEIMAT \*

### House A TOP A01.03

Level 1

No. of rooms	3
Size	ca. 147,90 m <sup>2</sup>
Terasse	ca. 39,37 m <sup>2</sup>
Condition	New construction
Orientation	Southwest
Parking area	On demand

#### Holiday home permission »new«

— You will find more information regarding the permission at [theheimat.at](http://theheimat.at) or in the brochure

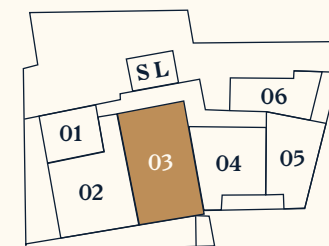
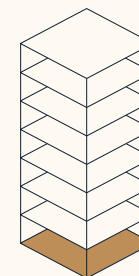

S — Staircase  
L — Lift







## \* THE HEIMAT \*

### House A TOP A01.04

Level 1

No. of rooms	3
Size	ca. 98,92 m <sup>2</sup>
Terasse	ca. 47,48 m <sup>2</sup>
Condition	New construction
Orientation	Southwest
Parking area	On demand

#### Holiday home permission »new«

— You will find more information regarding the permission at [theheimat.at](http://theheimat.at) or in the brochure

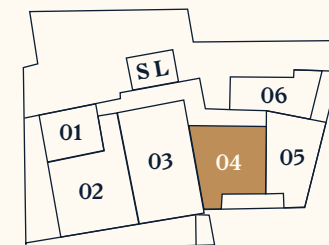
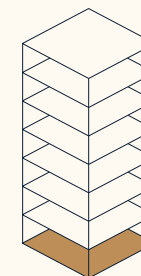

S — Staircase  
L — Lift





## \* THE HEIMAT \*

### House A TOP A01.05

Level 1

No. of rooms	2
Size	ca. 73,25 m <sup>2</sup>
Terasse	ca. 15,10 m <sup>2</sup>
Condition	New construction
Orientation	Southwest
Parking area	On demand

#### Investor apartment with self-use

— You will find more information regarding the permission at [theheimat.at](http://theheimat.at) or in the brochure

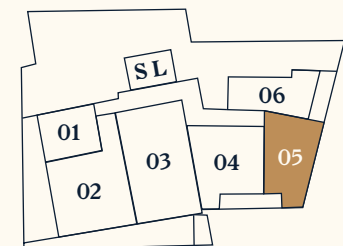
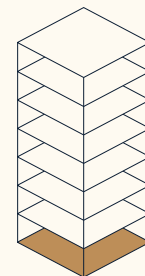

S — Staircase  
L — Lift







## \* THE HEIMAT \*

### House A TOP A01.06

Level 1

No. of rooms	2
Size	ca. 58,61 m <sup>2</sup>
Terasse	ca. 10,71 m <sup>2</sup>
Condition	New construction
Orientation	Southeast
Parking area	On demand

#### Investor apartment with self-use

— You will find more information regarding the permission at [theheimat.at](http://theheimat.at) or in the brochure

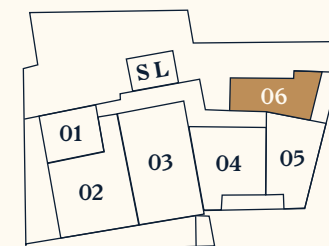
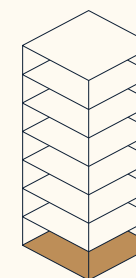

S — Staircase  
L — Lift





## \* THE HEIMAT \*

### House A TOP A00.01

Level 2

No. of rooms	4
Size	ca. 119,18 m <sup>2</sup>
Terrace	ca. 121,13 m <sup>2</sup>
Condition	New construction
Orientation	Southwest
Parking area	on demand

#### Chalet: Second residence

— You will find more information regarding the permission at [theheimat.at](http://theheimat.at) or in the brochure

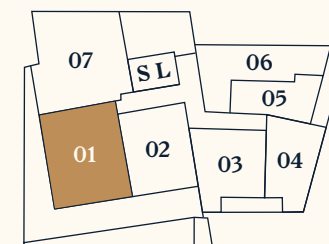
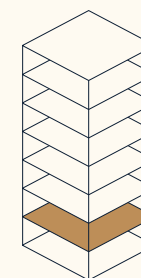

S — Staircase  
L — Lift





## \* THE HEIMAT \*

### House A TOP A00.02

Level 2

No. of rooms	3
Size	ca. 102,99 m <sup>2</sup>
Terasse	ca. 42,21 m <sup>2</sup>
Condition	New construction
Orientation	Southwest
Parking area	On demand

#### Holiday home permission »new«

— You will find more information regarding the permission at [theheimat.at](http://theheimat.at) or in the brochure

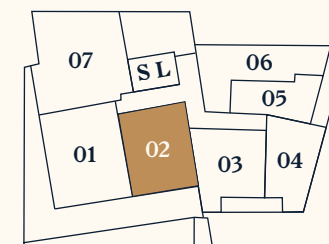
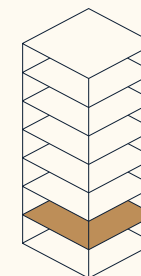

S — Staircase  
L — Lift







## \* THE HEIMAT \*

### House A TOP A00.03

Level 2

No. of rooms	3
Size	ca. 98,72 m <sup>2</sup>
Terasse	ca. 9,37 m <sup>2</sup>
Condition	New construction
Orientation	Southwest
Parking area	On demand

#### Investor apartment with self-use

— You will find more information regarding the permission at [theheimat.at](http://theheimat.at) or in the brochure

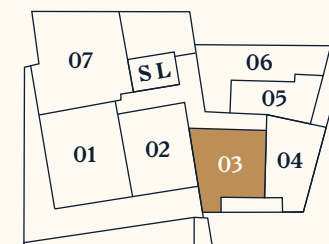
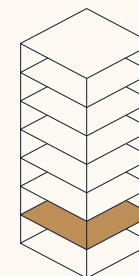

S — Staircase  
L — Lift





## \* THE HEIMAT \*

### House A TOP A00.04

Level 2

No. of rooms	2
Size	ca. 73,02 m <sup>2</sup>
Terasse	ca. 3,36 m <sup>2</sup>
Condition	New construction
Orientation	Southwest
Parking area	On demand

#### Investor apartment with self-use

— You will find more information regarding the permission at [theheimat.at](http://theheimat.at) or in the brochure

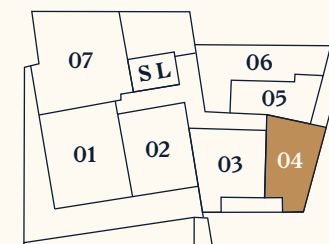
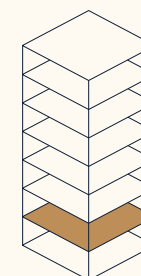

S — Staircase  
L — Lift





## \* THE HEIMAT \*

### House A TOP A00.05

Level 2

No. of rooms	2
Size	ca. 58,56 m <sup>2</sup>
Terasse	ca. 10,59 m <sup>2</sup>
Condition	New construction
Orientation	Southeast
Parking area	On demand

#### Investor apartment with self-use

— You will find more information regarding the permission at [theheimat.at](http://theheimat.at) or in the brochure

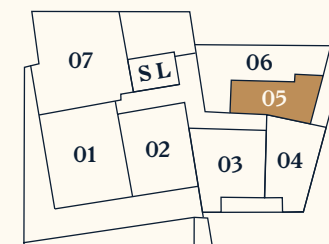
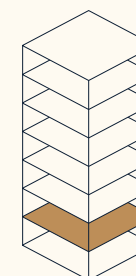

S — Staircase  
L — Lift





## House A TOP A00.06

Level 2

No. of rooms	3
Size	ca. 87,52 m <sup>2</sup>
Terasse	ca. 6,54 m <sup>2</sup>
Condition	New construction
Orientation	Southeast
Parking area	On demand

### Investor apartment with self-use

— You will find more information regarding the permission at [theheimat.at](http://theheimat.at) or in the brochure

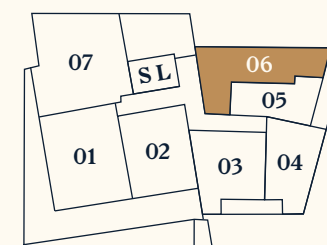
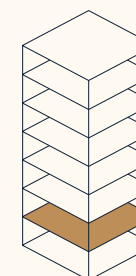

S — Staircase  
L — Lift





## \* THE HEIMAT \*

### House A TOP A00.07

Level 2

No. of rooms	4
Size	ca. 129,62 m <sup>2</sup>
Terasse	ca. 20,63 m <sup>2</sup>
Condition	New construction
Orientation	Southwest
Parking area	On demand

#### Holiday home permission »new«

— You will find more information regarding the permission at [theheimat.at](http://theheimat.at) or in the brochure

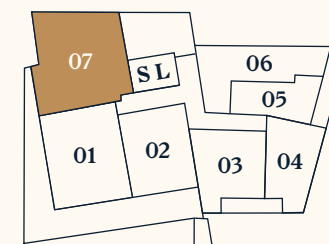
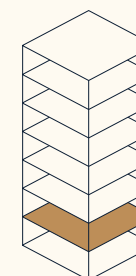

S — Staircase  
L — Lift





## \* THE HEIMAT \*

### House A TOP A10.01

Level 3

No. of rooms	3
Size	ca. 88,15 m <sup>2</sup>
Terasse	ca. 37,06 m <sup>2</sup>
Condition	New construction
Orientation	Southwest
Parking area	On demand

#### Holiday home permission »new«

— You will find more information regarding the permission at [theheimat.at](http://theheimat.at) or in the brochure

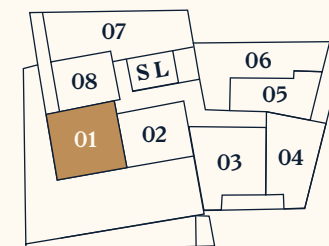
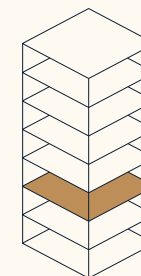

S — Staircase  
L — Lift







## \* THE HEIMAT \*

### House A TOP A10.02

Level 3

No. of rooms	3
Size	ca. 69,87 m <sup>2</sup>
Terasse	ca. 33,08 m <sup>2</sup>
Condition	New construction
Orientation	Southwest
Parking area	On demand

#### Holiday home permission »new«

— You will find more information regarding the permission at [theheimat.at](http://theheimat.at) or in the brochure

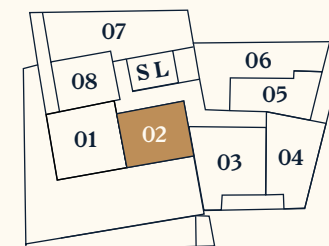
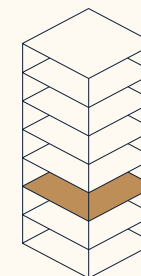

S — Staircase  
L — Lift





## \* THE HEIMAT \*

### House A TOP A10.03

Level 3

No. of rooms	3
Size	ca. 98,72 m <sup>2</sup>
Terasse	ca. 8,92 m <sup>2</sup>
Condition	New construction
Orientation	Southwest
Parking area	On demand

#### Holiday home permission »new«

— You will find more information regarding the permission at [theheimat.at](http://theheimat.at) or in the brochure

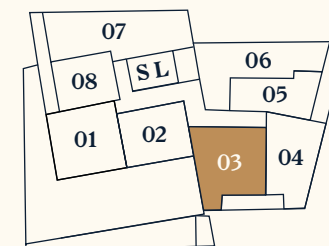
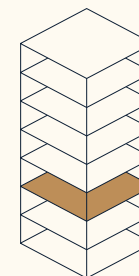

S — Staircase  
L — Lift





## \* THE HEIMAT \*

### House A TOP A10.04

Level 3

No. of rooms	2
Size	ca. 73,02 m <sup>2</sup>
Terasse	ca. 3,23 m <sup>2</sup>
Condition	New construction
Orientation	Southwest
Parking area	On demand

#### Holiday home permission »new«

— You will find more information regarding the permission at [theheimat.at](http://theheimat.at) or in the brochure

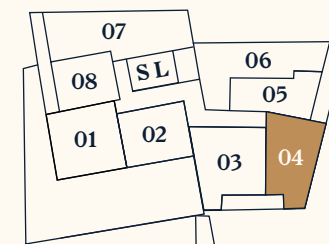
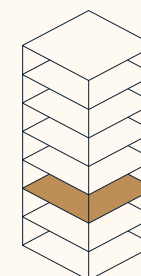

S — Staircase  
L — Lift





# \* THE HEIMAT \*

## House A TOP A10.05

Level 3

No. of rooms	2
Size	ca. 58,55 m <sup>2</sup>
Terasse	ca. 10,85 m <sup>2</sup>
Condition	New construction
Orientation	Southeast
Parking area	On demand

### Holiday home permission »new«

— You will find more information regarding the permission at [theheimat.at](http://theheimat.at) or in the brochure

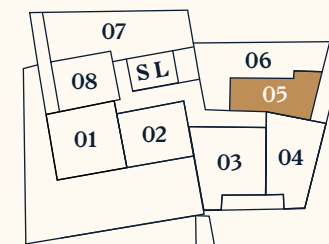
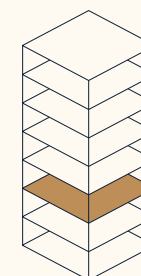

S — Staircase  
L — Lift





## \* THE HEIMAT \*

### House A TOP A10.06

Level 3

No. of rooms	3
Size	ca. 87,92 m <sup>2</sup>
Terasse	ca. 6,75 m <sup>2</sup>
Condition	New construction
Orientation	Southeast
Parking area	On demand

#### Holiday home permission »new«

— You will find more information regarding the permission at [theheimat.at](http://theheimat.at) or in the brochure

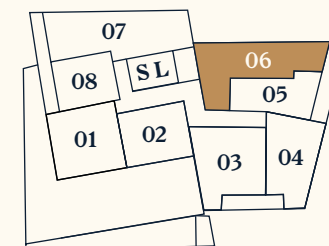
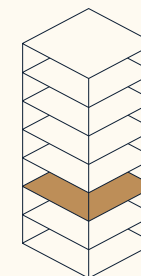

S — Staircase  
L — Lift



## House A TOP A10.07

Level 3



No. of rooms	3
Size	ca. 113,95 m <sup>2</sup>
Terasse	ca. 9,19 m <sup>2</sup>
Condition	New construction
Orientation	Northwest
Parking area	On demand

### Holiday home permission »new«

— You will find more information regarding the permission at [theheimat.at](http://theheimat.at) or in the brochure

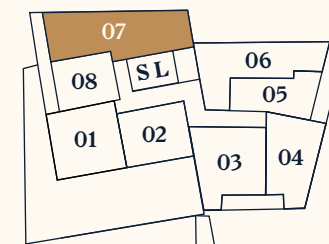
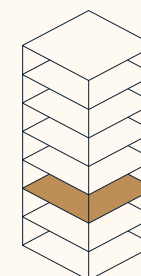

S — Staircase  
L — Lift



# \* THE HEIMAT \*

## House A TOP A10.08

Level 3



No. of rooms	2
Size	ca. 54,91 m <sup>2</sup>
Terasse	ca. 9,19 m <sup>2</sup>
Condition	New construction
Orientation	Northwest
Parking area	On demand

### Holiday home permission »new«

— You will find more information regarding the permission at [theheimat.at](http://theheimat.at) or in the brochure

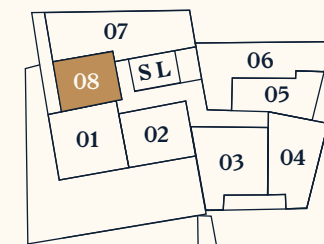
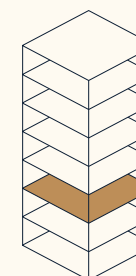

S — Staircase  
L — Lift







## \* THE HEIMAT \*

### House A TOP A20.01

Level 4

No. of rooms	3
Size	ca. 79,53 m <sup>2</sup>
Terasse	ca. 6,68 m <sup>2</sup>
Condition	New construction
Orientation	Southwest
Parking area	On demand

#### Holiday home permission »new«

— You will find more information regarding the permission at [theheimat.at](http://theheimat.at) or in the brochure

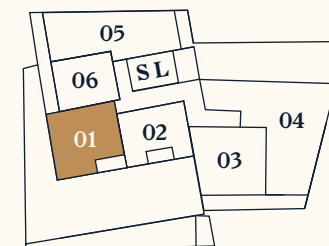
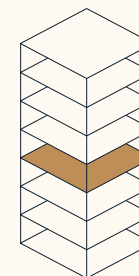

S — Staircase  
L — Lift





## \* THE HEIMAT \*

### House A TOP A20.02

Level 4

No. of rooms	3
Size	ca. 63,64 m <sup>2</sup>
Terasse	ca. 5,01 m <sup>2</sup>
Condition	New construction
Orientation	Southwest
Parking area	On demand

#### Holiday home permission »new«

— You will find more information regarding the permission at [theheimat.at](http://theheimat.at) or in the brochure

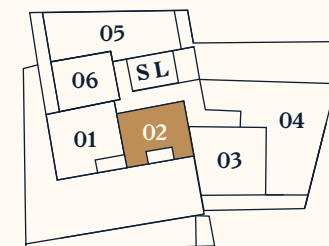
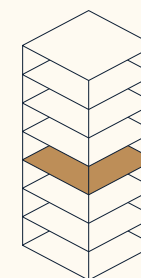

S — Staircase  
L — Lift





## \* THE HEIMAT \*

### House A TOP A20.03

Level 4

No. of rooms	3
Size	ca. 70,12 m <sup>2</sup>
Terasse	ca. 35,35 m <sup>2</sup>
Condition	New construction
Orientation	Southwest
Parking area	On demand

#### Holiday home permission »new«

— You will find more information regarding the permission at [theheimat.at](http://theheimat.at) or in the brochure

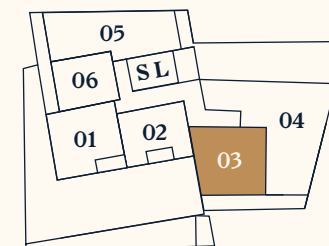
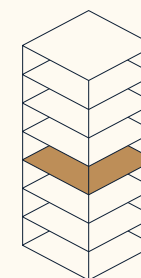

S — Staircase  
L — Lift





## \* THE HEIMAT \*

### House A TOP A20.04

Level 4

No. of rooms	4
Size	ca. 153,53 m <sup>2</sup>
Terasse	ca. 80,08 m <sup>2</sup>
Condition	New construction
Orientation	Southwest
Parking area	On demand

#### Holiday home permission »new«

— You will find more information regarding the permission at [theheimat.at](http://theheimat.at) or in the brochure

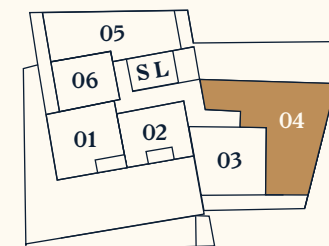
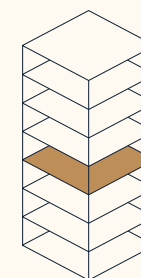

S — Staircase  
L — Lift





# \* THE HEIMAT \*

## House A TOP A20.05

Level 4



No. of rooms	3
Size	ca. 104,24 m <sup>2</sup>
Terasse	ca. 17,18 m <sup>2</sup>
Condition	New construction
Orientation	Northwest
Parking area	On demand

### Holiday home permission »new«

— You will find more information regarding the permission at [theheimat.at](http://theheimat.at) or in the brochure

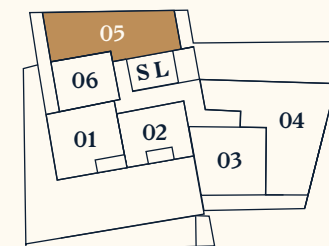
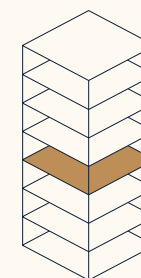

S — Staircase  
L — Lift



# \* THE HEIMAT \*

## House A TOP A20.06

Level 4



No. of rooms	2
Size	ca. 54,91 m <sup>2</sup>
Terasse	ca. 9,19 m <sup>2</sup>
Condition	New construction
Orientation	Northwest
Parking area	On demand

### Holiday home permission »new«

— You will find more information regarding the permission at [theheimat.at](http://theheimat.at) or in the brochure

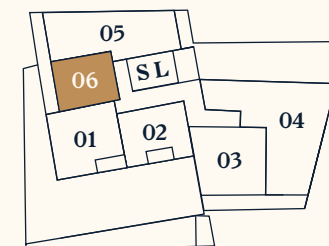
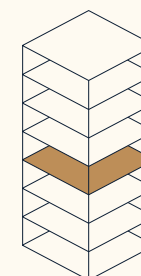

S — Staircase  
L — Lift





## \* THE HEIMAT \*

### House A TOP A30.01

Level 5

No. of rooms	3
Size	ca. 79,19 m <sup>2</sup>
Terasse	ca. 7,94 m <sup>2</sup>
Condition	New construction
Orientation	Southwest
Parking area	On demand

#### Holiday home permission »new«

— You will find more information regarding the permission at [theheimat.at](http://theheimat.at) or in the brochure

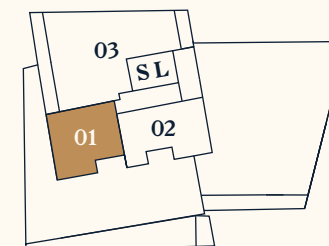
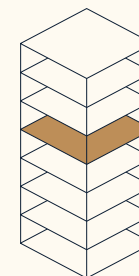

S — Staircase  
L — Lift



# \* THE HEIMAT \*

## House A TOP A30.02

Level 5



No. of rooms	3
Size	ca. 85,30 m <sup>2</sup>
Terasse	ca. 9,83 m <sup>2</sup>
Condition	New construction
Orientation	Southwest
Parking area	On demand

### Holiday home permission »new«

— You will find more information regarding the permission at [theheimat.at](http://theheimat.at) or in the brochure

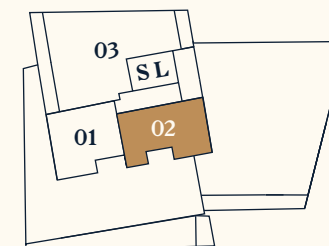
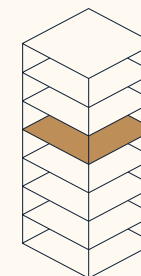

S — Staircase  
L — Lift





## House A TOP A30.03

Level 5



No. of rooms	5
Size	ca. 165,18 m <sup>2</sup>
Terasse	ca. 26,56 m <sup>2</sup>
Condition	New construction
Orientation	Northwest
Parking area	On demand

### Holiday home permission »new«

— You will find more information regarding the permission at [theheimat.at](http://theheimat.at) or in the brochure

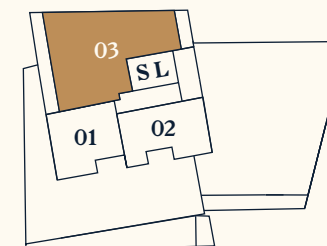
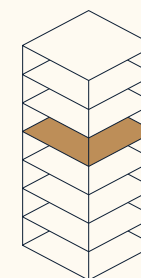

S — Staircase  
L — Lift





## \* THE HEIMAT \*

### House A TOP A40.01

Level 6 & 7

No. of rooms	4
Size	ca. 139,99 m <sup>2</sup>
Terasse	ca. 49,12 m <sup>2</sup>
Condition	New construction
Orientation	Northwest
Parking area	On demand

#### **Chalet: Second residence**

— You will find more information regarding the permission at [theheimat.at](http://theheimat.at) or in the brochure

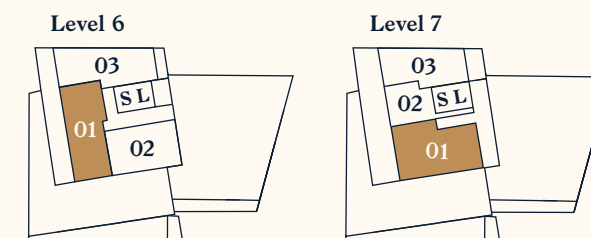
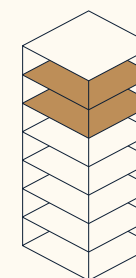

S — Staircase  
L — Lift





## \* THE HEIMAT \*

### House A TOP A40.02

Level 6 & 7

No. of rooms	5
Size	ca. 145,35 m <sup>2</sup>
Terasse	ca. 27,07 m <sup>2</sup>
Condition	New construction
Orientation	Southeast
Parking area	On demand

#### Chalet: Second residence

— You will find more information regarding the permission at [theheimat.at](http://theheimat.at) or in the brochure

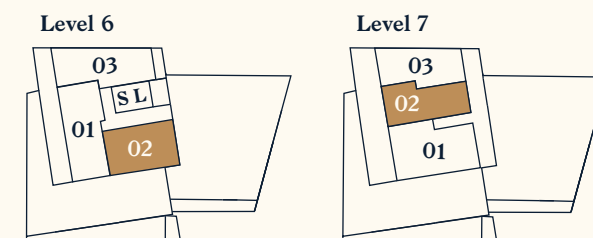
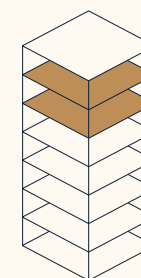

S — Staircase  
L — Lift





## \* THE HEIMAT \*

### House A TOP A40.03

Level 6 & 7

No. of rooms	5
Size	ca. 138,74 m <sup>2</sup>
Terasse	ca. 26,12 m <sup>2</sup>
Condition	New construction
Orientation	Northwest
Parking area	On demand

#### Chalet: Second residence

— You will find more information regarding the permission at [theheimat.at](http://theheimat.at) or in the brochure

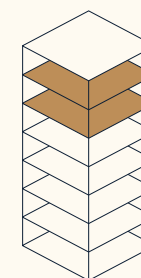

Level 6

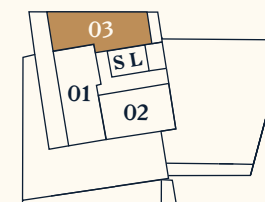

Level 7

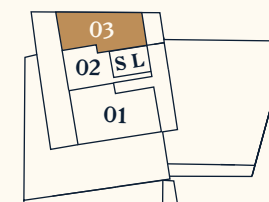

S — Staircase  
L — Lift







## \* THE HEIMAT \*

### House B TOP 2.B

Level 3

No. of rooms	2
Size	ca. 47,20 m <sup>2</sup>
Terasse	ca. 14,03 m <sup>2</sup>
Condition	Is being refurbished
Orientation	Northwest
Parking area	On demand

#### Investor apartment with self-use

— You will find more information regarding the permission at [theheimat.at](http://theheimat.at) or in the brochure

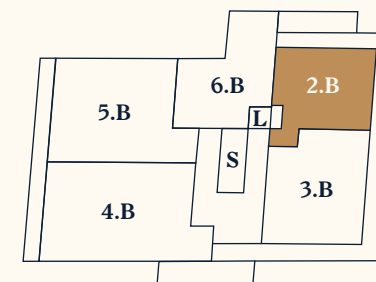
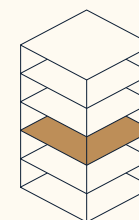

S — Staircase  
L — Lift





## \* THE HEIMAT \*

### House B TOP 3.B

Level 3

No. of rooms	2
Size	ca. 52,70 m <sup>2</sup>
Terasse	ca. 22,18 m <sup>2</sup>
Condition	Is being refurbished
Orientation	Northeast
Parking area	On demand

#### Investor apartment with self-use

— You will find more information regarding the permission at [theheimat.at](http://theheimat.at) or in the brochure

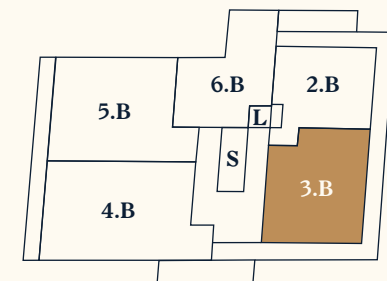
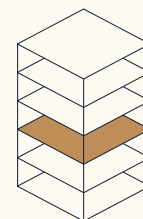

S — Staircase  
L — Lift





## \* THE HEIMAT \*

### House B TOP 4.B

Level 3

No. of rooms	3
Size	ca. 62,50 m <sup>2</sup>
Terasse	ca. 30,00 m <sup>2</sup>
Condition	Is being refurbished
Orientation	Southwest
Parking area	On demand

#### Investor apartment with self-use

— You will find more information regarding the permission at [theheimat.at](http://theheimat.at) or in the brochure

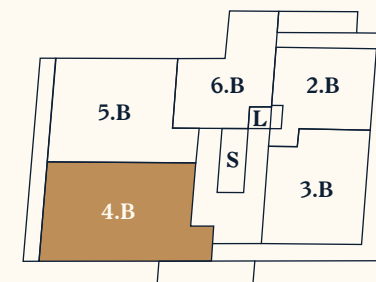
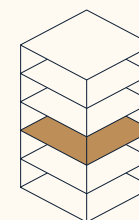

S — Staircase  
L — Lift





## \* THE HEIMAT \*

### House B TOP 5.B

Level 3

No. of rooms	2
Size	ca. 49,00 m <sup>2</sup>
Terasse	ca. 30,00 m <sup>2</sup>
Condition	Is being refurbished
Orientation	Southwest
Parking area	On demand

#### Investor apartment with self-use

— You will find more information regarding the permission at [theheimat.at](http://theheimat.at) or in the brochure

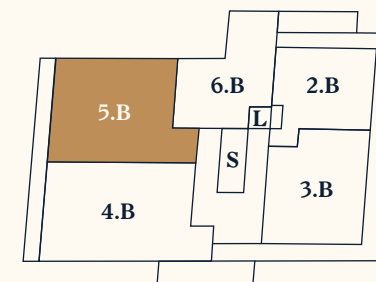
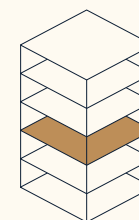

S — Staircase  
L — Lift





## \* THE HEIMAT \*

### House B TOP 6.B

Level 3

No. of rooms	2
Size	ca. 38,60 m <sup>2</sup>
Condition	Is being refurbished
Orientation	Northwest
Parking area	On demand

#### Investor apartment with self-use

— You will find more information regarding the permission at [theheimat.at](http://theheimat.at) or in the brochure

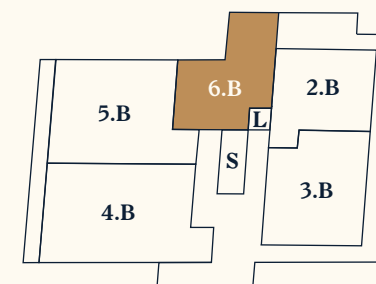
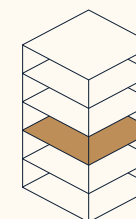

S — Staircase  
L — Lift







## \* THE HEIMAT \*

### House B TOP 7.B

Level 4

No. of rooms	2
Size	ca. 47,20 m <sup>2</sup>
Terasse	ca. 8,50 m <sup>2</sup>
Condition	Is being refurbished
Orientation	Northwest
Parking area	On demand

#### **Investor apartment with self-use**

— You will find more information regarding the permission at [theheimat.at](http://theheimat.at) or in the brochure

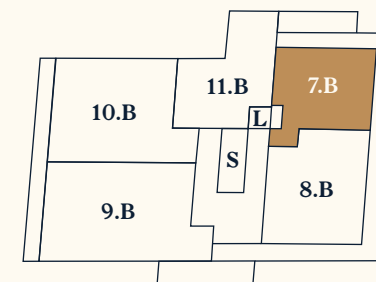
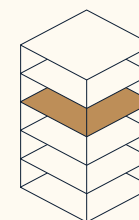

S — Staircase  
L — Lift





## \* THE HEIMAT \*

### House B TOP 8.B

Level 4

No. of rooms	2
Size	ca. 52,70 m <sup>2</sup>
Terasse	ca. 13,80 m <sup>2</sup>
Condition	Is being refurbished
Orientation	Southeast
Parking area	On demand

#### Investor apartment with self-use

— You will find more information regarding the permission at [theheimat.at](http://theheimat.at) or in the brochure

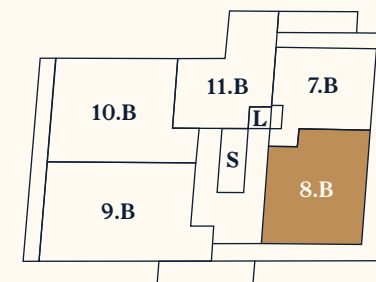
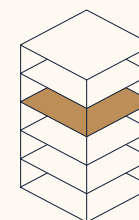

S — Staircase  
L — Lift



# \* THE HEIMAT \*

## House B TOP 9.B

Level 4



No. of rooms	3
Size	ca. 62,50 m <sup>2</sup>
Terasse	ca. 13,70 m <sup>2</sup>
Condition	Is being refurbished
Orientation	Southwest
Parking area	On demand

### Investor apartment with self-use

— You will find more information regarding the permission at [theheimat.at](http://theheimat.at) or in the brochure

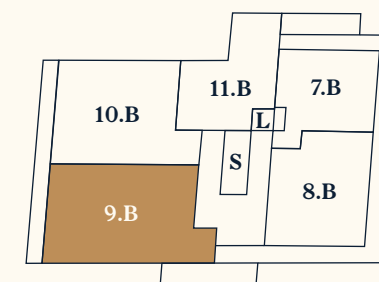
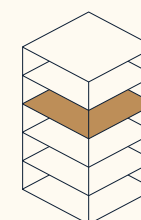

S — Staircase  
L — Lift





## \* THE HEIMAT \*

### House B TOP 10.B

Level 4

No. of rooms	2
Size	ca. 49,00 m <sup>2</sup>
Terasse	ca. 13,70 m <sup>2</sup>
Condition	Is being refurbished
Orientation	Southwest
Parking area	On demand

#### Investor apartment with self-use

— You will find more information regarding the permission at [theheimat.at](http://theheimat.at) or in the brochure

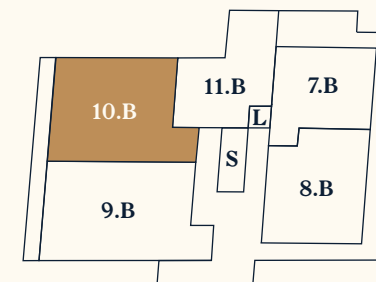
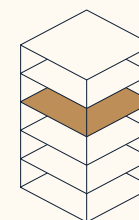

S — Staircase  
L — Lift





## \* THE HEIMAT \*

### House B TOP 11.B

Level 4

No. of rooms	2
Size	ca. 38,60 m <sup>2</sup>
Condition	Is being refurbished
Orientation	Northwest
Parking area	On demand

#### Investor apartment with self-use

— You will find more information regarding the permission at [theheimat.at](http://theheimat.at) or in the brochure

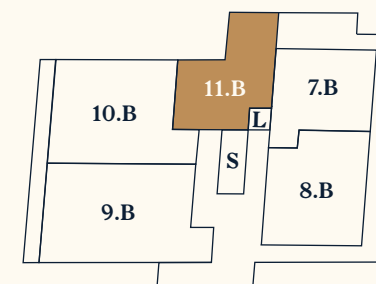
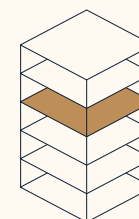

S — Staircase  
L — Lift







## \* THE HEIMAT \*

### House B TOP 12.B

Level 5

No. of rooms	2
Size	ca. 44,50 m <sup>2</sup>
Condition	Is being refurbished
Orientation	Northwest
Parking area	On demand

#### Investor apartment with self-use

— You will find more information regarding the permission at [theheimat.at](http://theheimat.at) or in the brochure

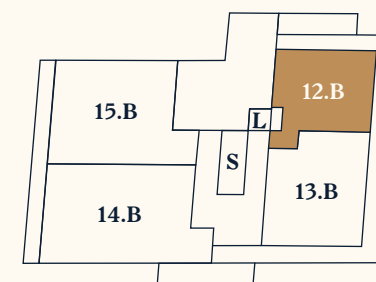
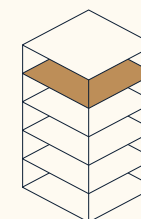

S — Staircase  
L — Lift





## \* THE HEIMAT \*

### House B TOP 13.B

Level 5

No. of rooms	2
Size	ca. 52,70 m <sup>2</sup>
Condition	Is being refurbished
Orientation	Southeast
Parking area	On demand

#### Investor apartment with self-use

— You will find more information regarding the permission at [theheimat.at](http://theheimat.at) or in the brochure

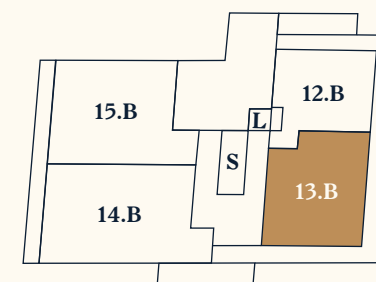
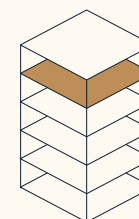

S — Staircase  
L — Lift



# \* THE HEIMAT \*

## House B TOP 14.B

Level 5



No. of rooms	3
Size	ca. 61,20 m <sup>2</sup>
Terasse	ca. 7,22 m <sup>2</sup>
Condition	Is being refurbished
Orientation	Southwest
Parking area	On demand

### Investor apartment with self-use

— You will find more information regarding the permission at [theheimat.at](http://theheimat.at) or in the brochure

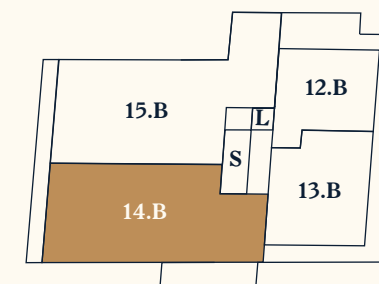
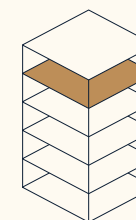

S — Staircase  
L — Lift



# \* THE HEIMAT \*

## House B TOP 15.B

Level 5



No. of rooms	3
Size	ca. 83,60 m <sup>2</sup>
Terasse	ca. 11,70 m <sup>2</sup>
Condition	Is being refurbished
Orientation	Southwest
Parking area	On demand

### Investor apartment with self-use

— You will find more information regarding the permission at [theheimat.at](http://theheimat.at) or in the brochure

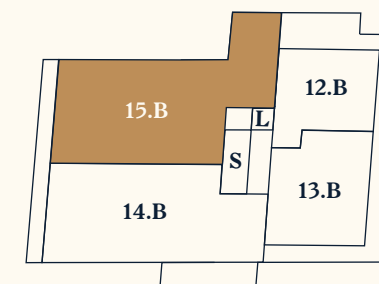
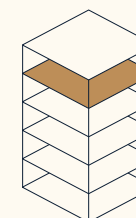

S — Staircase  
L — Lift





## \* THE HEIMAT \*

### House B TOP 16.B

Level 1

No. of rooms	2
Size	ca. 65,35 m <sup>2</sup>
Terasse	ca. 14,00 m <sup>2</sup>
Condition	Is being refurbished
Orientation	Northwest
Parking area	On demand

#### Investor apartment with self-use

— You will find more information regarding the permission at [theheimat.at](http://theheimat.at) or in the brochure

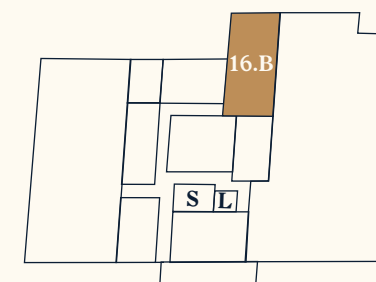
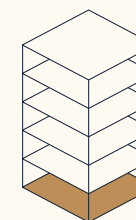

S — Staircase  
L — Lift







## \* THE HEIMAT \*

### House C TOP 5.C

Level 1

No. of rooms	2
Size	ca. 47,08 m <sup>2</sup>
Terasse	ca. 9,06 m <sup>2</sup>
Condition	Is being refurbished
Orientation	Northeast
Parking area	On demand

#### Investor apartment with self-use

— You will find more information regarding the permission at [theheimat.at](http://theheimat.at) or in the brochure

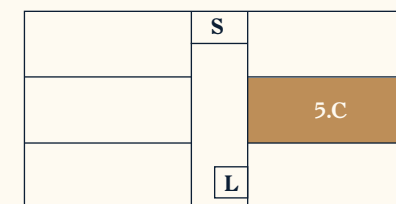
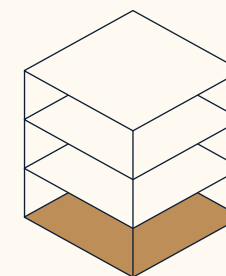

S — Staircase  
L — Lift





## \* THE HEIMAT \*

### House C TOP 15.C

Level 2

No. of rooms	2
Size	ca. 47,08 m <sup>2</sup>
Terasse	ca. 9,06 m <sup>2</sup>
Condition	Is being refurbished
Orientation	Southwest
Parking area	On demand

#### Investor apartment with self-use

— You will find more information regarding the permission at [theheimat.at](http://theheimat.at) or in the brochure

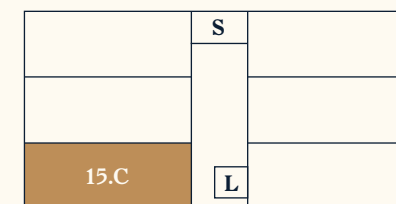
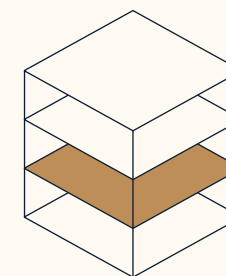

S — Staircase  
L — Lift





## \* THE HEIMAT \*

### House C TOP 16.C

Level 3

No. of rooms	2
Size	ca. 47,08 m <sup>2</sup>
Terasse	ca. 9,06 m <sup>2</sup>
Condition	Refurbished
Orientation	Northeast
Parking area	On demand

#### Investor apartment with self-use

— You will find more information regarding the permission at [theheimat.at](http://theheimat.at) or in the brochure

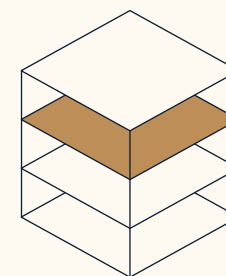

	S	16.C
		17.C
	L	18.C

S — Staircase  
L — Lift





## \* THE HEIMAT \*

### House C TOP 17.C

Level 3

No. of rooms	2
Size	ca. 47,08 m <sup>2</sup>
Terasse	ca. 9,06 m <sup>2</sup>
Condition	Refurbished
Orientation	Northeast
Parking area	On demand

#### Investor apartment with self-use

— You will find more information regarding the permission at [theheimat.at](http://theheimat.at) or in the brochure

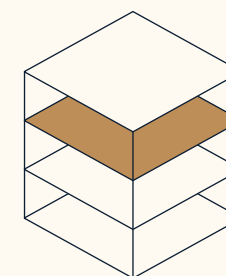

	S	16.C
		17.C
	L	18.C

S — Staircase  
L — Lift





## \* THE HEIMAT \*

### House C TOP 18.C

Level 3

No. of rooms	2
Size	ca. 47,02 m <sup>2</sup>
Terasse	ca. 9,06 m <sup>2</sup>
Condition	Refurbished
Orientation	Northeast
Parking area	On demand

#### Investor apartment with self-use

— You will find more information regarding the permission at [theheimat.at](http://theheimat.at) or in the brochure

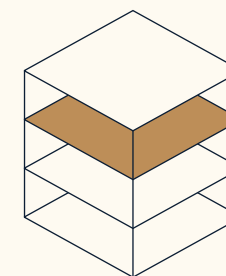

	S	16.C
		17.C
	L	18.C

S — Staircase  
L — Lift





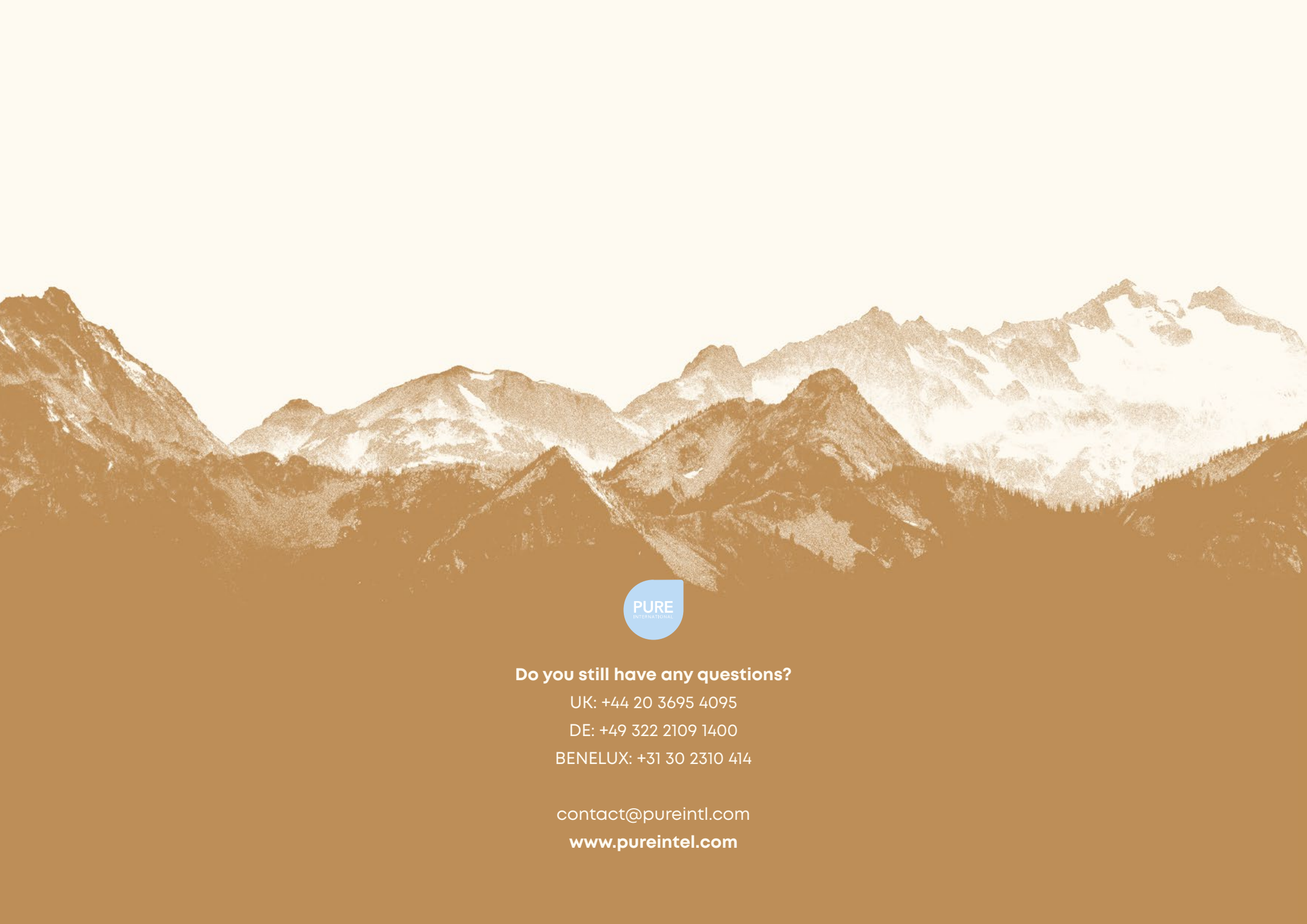

**Do you still have any questions?**

UK: +44 20 3695 4095

DE: +49 322 2109 1400

BENELUX: +31 30 2310 414

[contact@pureintl.com](mailto:contact@pureintl.com)

[www.pureintel.com](http://www.pureintel.com)